

4-WAY ADAPTOR

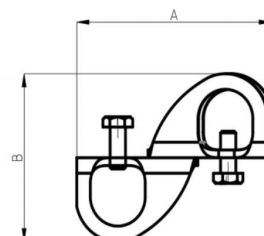

Function: Can be used for four direction pipe fixation. Suitable for fixing pipe \leq DN200

Material: Carbon steel

Finish: Electro-galvanized

Ordering: Specify Size.

Item	Size	A	B	Maximum design load		
		mm	mm	LBS	Kg	N
GJSX	1"	121	95	1000	450	4450